





CALGARY AIRPORT



by CLIQUE

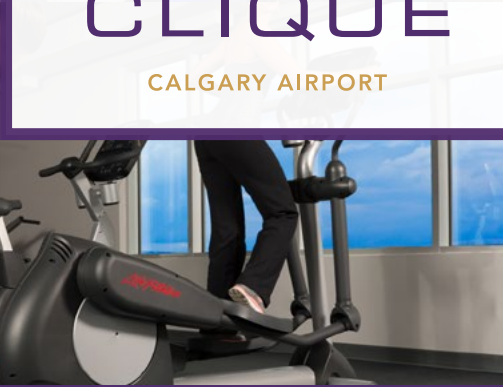

# NEXT LEVEL SERVICE.

## IT'S A CLIQUE THING.

### HOTEL AMENITIES

- 24-hour airport shuttle
- Over 4,500 sq. ft. of meeting & event space
- WiFi throughout the hotel
- Two rooftop hot tubs and skydeck
- 800 sq. ft. modern fitness centre with windows
- Tonic Kitchen + Bar - open for breakfast, lunch & dinner

#### HOTEL CLIQUE GUESTROOMS

hotelclique.ca | 24 Aero Crescent NE, Calgary, AB T2E 7Y5  
1.855.425.4783

**49 EXQUISITE KING ROOMS**    **51 EXQUISITE QUEEN ROOMS**  
360 sq. ft. Room with 1 King Bed    360 sq. ft Room with 2 Queen Beds

#### ROOM FEATURES

- Full bath including a deep soaker tub and shower panel with body jets
- Keurig coffee maker
- Mini fridge
- 47" LED TV with full HD channel line up
- Large desk and speaker phone
- Blu-Ray player

#### APPLAUSE HOTEL GUESTROOMS

applausehotel.ca | 20 Aero Crescent NE, Calgary, AB T2E 7Y5  
1.855.425.4783

**49 EXQUISITE KING ROOMS**    **51 EXQUISITE QUEEN ROOMS**  
360 sq. ft. Room with 1 King Bed    360 sq. ft Room with 2 Queen Beds

#### ROOM FEATURES

- Hot cooked to order breakfast for two
- Stand-up shower with body jets
- Tassimo coffee maker
- Mini fridge
- 47" LED TV with full HD channel line up
- Large desk and speaker phone
- Blu-Ray player
- 10 enhanced amenities

## TONIC KITCHEN + BAR

### AWARD WINNING TONIC BURGER

Located adjacent to the hotel lobby, Tonic is a full service restaurant open for breakfast, lunch and dinner. In the morning guests can be seated and enjoy a hot breakfast at their leisure. If on the move, Tonic offers the convenience to grab a fresh breakfast item and coffee from our To Go Breakfast Bar. Lunch and dinner are enjoyed in Tonic's warm dining room where one will want to try our selection of over 50 world class vodkas and gins, as well as, our selection of Porter's Tonic water.





**HOTEL  
CLIQUE**  
CALGARY AIRPORT

**APPLAUSE  
HOTEL**  
••• by CLIQUE •••

## CONFERENCE AND EVENT SPACE

Hotel Clique offers five event spaces with a total of over 4,500 sq. ft. Located on the second floor of the hotel all meeting rooms offer large windows with natural light that can be blacked out when required. There are no columns or obstructions in any of the event spaces to impact sight lines. Our attentive catering staff will make meals and breaks a culinary hit. Breaks and receptions can be offered in the 1,000 sq. ft. lounge outside the meeting rooms.

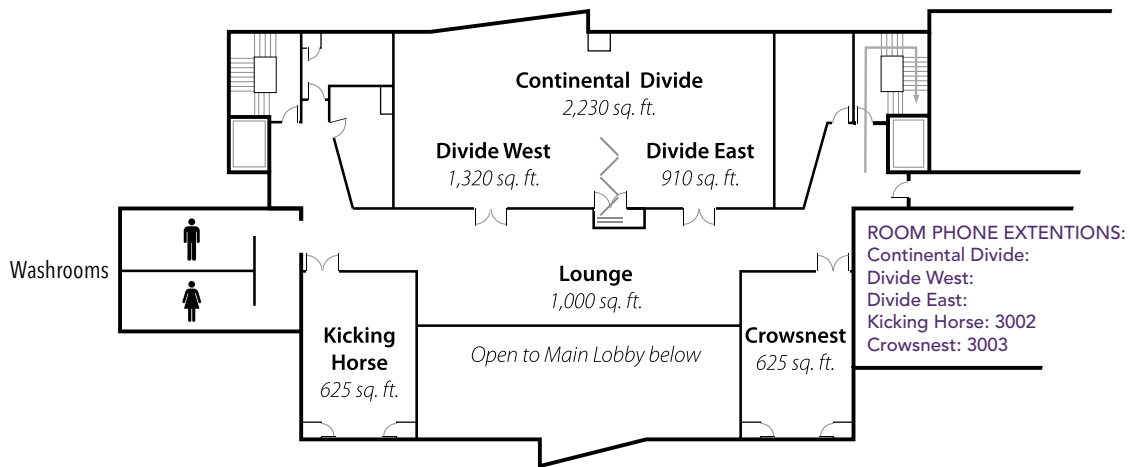

MEETING ROOM	SPACE SQ. FT.	CEILING HT.	SIZE	U SHAPE	BANQUET	COCKTAIL	THEATRE	CLASSRM	BOARDRM
CONTINENTAL DIVIDE	2230	10'	33' x 67'	80	160	180	200	120	75
DIVIDE WEST	1320	10'	33' x 40'	40	60	80	100	80	40
DIVIDE EAST	910	10'	33' x 27'	30	40	60	80	40	35
KICKING HORSE	625	10'	33' x 20'	24	32	50	50	36	20
CROWSNEST	625	10'	33' x 20'	24	32	50	50	36	20
LOUNGE	1000	10'	-	-	-	-	-	-	-

[hotelclique.ca](http://hotelclique.ca) | [applausehotel.ca](http://applausehotel.ca)

